

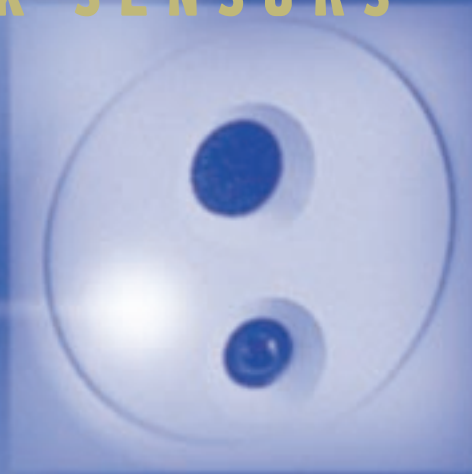

GLASSBREAK SENSORS



SENTROL



INNOVATIVE SOLUTIONS FOR REAL-WORLD PROBLEMS

Since our founding in 1977, Sentrol has advanced the security and lifesafety industry by continually producing innovative solutions for real-world problems.

Today, Sentrol products are the choice of more than 10,000 security installation companies from the United States to Russia, from

South America to Asia.

Millions of Sentrol sensors protect high-profile facilities throughout the World.



RESOURCEFUL SOLUTIONS MAKE IT EASY

From high-security to best-value solutions, Sentrol offers full product lines to meet all of your

applications. Dealer/installers have come to rely on Sentrol for creative ideas that make installation & service easier, reduce costs, and boost customer satisfaction.

COMMITMENT TO QUALITY AND GROWTH BRINGS TOMORROW'S ANSWERS

Sentrol's ISO-9001 World-Class Manufacturing center in Portland, Oregon, produces products that offer years of dependable, trouble-free operation. To support our continued focus on inventive solutions, we are expanding our global resource base with engineering and manufacturing facilities throughout North America, Europe, South Africa, and Asia.



Sentrol products protect the White House, the Pentagon, and the Smithsonian Institute.

Today, we manufacture complete product lines under several well-known brands:

SENTROL

ESL™ Aritech™ Moose™ GBC™ Kalatel™
Fiber Options™ Impac Technologies™

SENTROL INNOVATIONS:

- Range-Controlled Radar™ motion sensor
- CleanMe® smoke detector remote maintenance alert
- Smoke detector self-diagnostics
- ShatterPro™ First and smallest recessed glassbreak sensor
- R1078 Drop-in channel magnet
- High-Performance FM Wireless System
- Vacuum Florescent Display keypad

SENTROL GLASSBREAK – SOLUTIONS WITHOUT COMPROMISES

Most glassbreak sensors give you a choice you'd rather not make: reliable detection or false alarm immunity — but not both. With glassbreak sensors from Sentrol, there's no need to compromise. Ongoing research and development combined with tomorrow's vision help us create extraordinary solutions for your toughest problems.



Sentrol glassbreak products blend application expertise, advanced detection technology, attractive design, and false alarm reduction features.

The result: uncompromising detection and false alarm immunity. You'll benefit with more repeat business, higher customer retention, and additional referrals.

GLASSBREAK INNOVATION HIGHLIGHTS

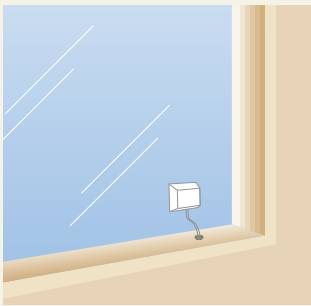

YESTERDAY

5150 Shock Sensor

The World's #1 self-powered piezo shock sensor, designed to save installation costs and recently improved with a low-profile design.

- *Over 3 million installed*



TODAY

Recessed ShatterPro II

The industry's first and smallest recessed glassbreak sensor is your best solution when appearance is a consideration.



TOMORROW

5812 ShatterPro NT

This next-generation glassbreak sensor offers range adjustments for small and large rooms, plus an all-new, easy-access design.

GLASSBREAK UNIVERSITY III

Updated for Year 2000, Sentrol's accredited, field-tested training program is designed for dealer sales, installation and service staff. You'll learn about the science of glassbreak detection and how to sell the benefits of perimeter protection.



5812NT ShatterPro™ III

- Small/large room setting
- Sequential pattern recognition technology
- Protects all types of glass
- 25' range



R5812NT ShatterPro™ III

- Small/large room setting
- Sequential pattern recognition technology
- Protects all types of glass
- 25' range

Ordering Information	Model Number	Listing
ShatterPro III 25' coverage, omni-directional	5812NT	
ShatterPro III 25' coverage, omni-directional	5815NT	

Ordering Information	Model Number	Listing
ShatterPro III 25' coverage, omni-directional	R5812NT	
ShatterPro III 25' coverage, omni-directional	R5815NT	



5600/5620 ShatterPoint™ Residential

- “Tru-Dual” Transducer Sensor
- 10' (3.0m) range on fixed pane, 8' (2.4m) multiple pane, measured to farthest point of glass
 - Protects all types of glass
 - Minimum glass size 1' by 1'



5650/5655C ShatterPoint™ Commercial

- “Tru-Dual” Transducer Sensor
- 10' (3.0m) range on fixed pane, 8' (2.4m) multiple pane, measured to farthest point of glass
 - Protects all types of glass
 - Minimum glass size 2' by 3'

Ordering Information	Model Number
ShatterPoint Residential	5600/W
ShatterPoint Residential With Form C relay and tamper switch	5605/W
ShatterPoint Residential With magnetic contact	5620/W
ShatterPoint Residential With Form C relay, tamper switch, and magnetic contact	5625/W
ShatterPoint Residential Wireless 3V tamper switch and magnetic contact	564503/W

Ordering Information	Model Number
ShatterPoint Commercial With Form A relay and tamper switch	5650C/W
ShatterPoint Commercial With Form C relay and tamper switch	5655C/W



GS610 On-the-Glass or Frame Sensor and Analyzer

- Can be installed on walls or roofs for special perimeter detection
- Designed for use with GS614/615/617 analyzer module for sensitivity and pulse count selection
- Up to 20 sensors can be connected to each analyzer



GS611 On-the-Glass or Frame Sensor and Analyzer

- Can be installed on walls or roofs for special perimeter detection
- Designed for use with GS614/615/617 analyzer module for sensitivity and pulse count selection
- Up to 20 sensors can be connected to each analyzer

Ordering Information	Model Number
Inertia Shock Sensor With 2M jacketed cable	GS600/W
Inertia Shock Sensor	GS610/W GS610/B

Ordering Information	Model Number
Inertia Shock Sensor With reed switch	GS611/W GS611/B

G L A S S B R E A K



5885 ShatterPro™ Plus Motion-Sensitive Acoustic Glassbreak Sensor

- Can function as two sensors in one package (PIR/Glassbreak)
- 24 hour acoustic glassbreak application

Ordering Information	Model Number
ShatterPro Plus Motion-sensitive acoustic glassbreak sensor	5885/W



5820 Recessed ShatterPro™ II

- Recess mounted directly in any ceiling or wall
- 360° coverage pattern
- 25' (7.5m), 360° range measured to the farthest point on all types of glass
- Protects all glass types up to a standard thickness of 1/4" (0.64cm) including plate, wired, tempered and laminated glass

Ordering Information	Model Number	Listing
Recessed ShatterPro II 1" (2.5cm) recessed mounting, latch or non-latch LED	5820A/W	
Recessed ShatterPro II with Tamper 1" (2.5cm) recessed mounting, latch or non-latch LED	5822A/W	
ShatterPro II 5820A with Single Gang Box Kit	5825A/W	



5150 Shock Sensor

On-the-Glass Protection

- 10' (3.0m) protection on a single pane of glass
- Detects all glass types without sensitivity adjustment
- On-the-glass mounting is visible from the outside to deter potential intruders
- Field proven with over 3 million installations around the world

Ordering Information	Model Number	Listing
Shock Sensor 10' (3.0m) range, two-wire, adhesive mount	5150/M 5150/W	
Shock Sensor with Coil Cord 10' (3.0m) range, two-wire, 3' (0.91m) coil cord for doors and windows	5150C/M 5150C/W	
Shock Sensor with LED Corner mount with range verification, two-wire, set-up LED, and sensitivity adjustment	5125/M 5125/N	



5400 Glassbreak Shock Sensor

- Protects 10' (3.0m) of glass
- Protects all glass types up to a standard thickness of 1/4" (0.64cm) including plate, wired, tempered and laminated glass
- Protects multi-pane windows
- Set-up LED

Ordering Information	Model Number	Listing
Glassbreak Shock Sensor Two-wire, closed loop, lithium battery powered (included)	5414/M 5414/W	
Glassbreak Shock Sensor Two-wire, closed loop, lithium battery powered (included), reed switch and magnet	5415A/M 5415A/W	
Glassbreak Shock Sensor Four-wire, closed loop, latching LED option	5425/M 5425/W	

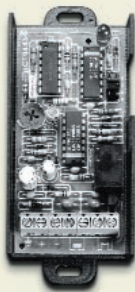

GS614/615

- Up to 20 sensors can be connected to each analyzer
- Adjustable sensitivity

Ordering Information	Model Number
Single Zone Analyzer	GS614/W
Single Zone Analyzer With terminal reset	GS615/W



GS617

- Up to 20 sensors can be connected to each analyzer
- Adjustable sensitivity

Ordering Information	Model Number
Four Zone Analyzer With EOL resistor and manual reset	GS617/W

S E N S O R S



5845 Wireless ShatterPro™

- 20' (6.0m), 360° range to farthest point on all glass
- Protects all glass types
- Compatible with virtually all wireless transmitters

Ordering Information	Model Number
Wireless ShatterPro Compatible with 3-volt transmitters, mounting bracket included	584503/W
Wireless ShatterPro Compatible with 9-volt transmitters, mounting bracket included	584509/W



5402/5422 Metal Enclosure Assault Sensor

- Protects sheet metal enclosures up to 2' x 4' x 1' (61cm x 122cm x 30.5cm)
- Replaces costly lined boxes
- Detects drilling, sawing and other assaults to metal enclosures

Ordering Information	Model Number	Listing
Metal Enclosure Assault Sensor Two-wire, lithium battery powered (included)	5402/W	UL LISTED UIC
Metal Enclosure Assault Sensor Four-wire, external powered	5422/W	UL LISTED UIC



Give our sensors a try in your toughest application. If they don't solve your problem, we'll give you \$50 in Sentrol product credit. How can you lose? Call us for details.



DV1201/1221 Advisor X Vibration Sensor

- Detects structural vibration generated in walls, floors, ceilings and doors
- Sensitivity adjustment discriminates between real attempts and nuisance alarms
- Helps prevent intrusion via hammers, drills, pressure and thermal tools, and explosives

Ordering Information	Model Number	Listing
Structural Vibration Sensor For vaults and safes, mounting plate included	DV1201	UL LISTED UIC
Structural Vibration Sensor For ATMs and night deposit safes, mounting plate included	DV1221	UL LISTED UIC
Self-Contained Test Transmitter Testing Accessory	DV1215	
Test System Panel Eight-Point Remote Annunciator/Test Accessory	DV1208A	

ACCESSORIES



5709C/W

Handheld tester with real glass break sounds



1838/N

Replacement Magnet



5828A/W

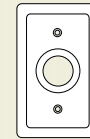

5829A/W

Ordering Information	Model Number
Hand-held Tester For testing effective range	5709C/W0
Replacement Magnet	1838/N

Ordering Information	Model Number
Trim Plate	5828A/W
Single Gang Box Plate	5829A/W

SAFE & VAULT ACCESSORIES

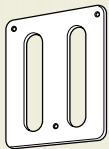

DV1212

Steel Mounting Plate: For mounting the detector on a steel surface by welding

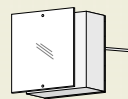

DV1203

Recess Mounting Kit: For the detector. Used for vaults under construction to create a recess mounting cavity in concrete.

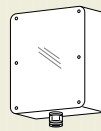

DV1204

Weather Protection Box: Mounting box to protect the detector in severe environments.

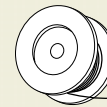

WS300/302

High Security Cable



DV1230

Safe Application Test Sensor

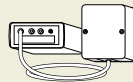

DV1160

DV Seismic Detector

Additional Accessories Available:

Plastic Cable Inserts (DV1216, DV1217, DV1218)

Metal Junction Box (DV1228)

Floor Mounting Box (DV1220)

Ordering Key

Color	Product # Suffix
White	W
Brown	M
Gray	G



SENTROL

GLASSBREAK SENSORS SPECIFICATIONS

ShatterPro™ II/ShatterPro™ EZ Recessed ShatterPro™ II / ShatterPro™ Plus

Operational voltage 9 - 16 V DC
Current draw . . . 12mA typical; 25mA max., 5885: 15mA typical;
30mA max.
Relay output 16V, 50mA, open 4 seconds on alarm
Lightning suppression 400 watts for 1 msec. pulse

Wireless ShatterPro 3-Volt

Operational voltage 2.8-4.5 V DC
Current draw . . . 17mA typical, max. 5mA w/ LED momentarily ON
Alarm output, Norm high or Norm low 4 seconds on alarm
Lightning suppression 400 watts for 1 msec. pulse

Wireless ShatterPro 9-Volt

Operational voltage 6-16 V DC
Current draw . . . 23mA typical, max. 5mA w/ LED momentarily ON
Alarm output, Norm high or Norm low 4 seconds on alarm
Lightning suppression 400 watts for 1 msec. pulse

5150/20 Shock Sensor

Resistance:
Normal 14 Ohms (20 Ohms max.)
Alarm 1 megOhm minimum
Time open on alarm 1-10 seconds
Maximum loop rating 15 V DC, 15mA
Lightning suppression 400 watts for 1 msec. pulse

5125 Shock Sensor

Operational voltage 9-16 V DC (5135 only)
Resistance
Normal 14 Ohms (20 Ohms max.)
Alarm 1 megOhm minimum
Time open on alarm 1-10 seconds, 5135: 2-5 seconds
Maximum loop rating 16 V DC, 50mA
Lightning suppression 400 watts for 1 msec. pulse

5400 Series Glassbreak Shock Sensor

Operational voltage 9-16 V DC
Current draw 10mA typical, 15mA max.
Time open on alarm 2-6 seconds
Maximum loop rating 16 V DC, 50mA
Lightning suppression 400 watts for 1msec. pulse

5402/5422 Metal Enclosure Shock Sensor

Operational voltage 9-24 V DC
Current draw Self Powered/15mA max.
Time open on alarm 2-6 seconds
Maximum loop rating 24V DC, 50mA
Lightning suppression 400 watts for 1 msec. pulse

5600 Series ShatterPoint™ “Tru-Dual” Transducer Sensor

Operational voltage 9-16 V DC
Current draw 12mA typical, 20mA max.
Relay output Normally closed, open 4 sec. on alarm
Maximum loop rating 16 V DC, 50mA

GS610/611 Glassbreak Shock Sensor

Operational voltage 10-15 V DC
Resistance <0.3 ohms
Current draw 35mA
Time open on alarm 2-5 seconds
Maximum loop rating 12V DC, 1A

GS614/615/617 Analyzer

Operational voltage 10-15 V DC
Current draw 10.5-15 V DC
Time open on alarm 614/615 50mA max., 10mA min./
617 135mA zones closed max. 20mA
Maximum loop rating 614/615/617 1A-12 V DC

DV1200 Series Advisor X Vibration Sensor

Operational voltage 10.7-15 V DC
Current draw 17mA typical
Time open on alarm 1-2 seconds
Maximum loop rating 15 V DC, 100mA

©1999 Sentrol. Sentrol reserves the right to change specifications without notice.
Sentrol and ShatterPro are registered trademarks of Sentrol.
Shatterpoint is a trademark of Sentrol.

M3925A-60K-1099

