



www.infographicsystems.com
www.GE-Interlogix.com

Sapphire Pro

High-end access control for enterprise solutions

Overview

The Sapphire Pro system provides a fully integrated solution for access control, security, alarm monitoring and photo ID badging applications. Sapphire Pro is ideally suited for medium to high-end sized facilities and delivers unsurpassed simplicity and performance with such original tools as Auto Configuration, Data Guard and Instant Access. Sapphire Pro's unique Internet browser platform and Interactive Color Graphics features redefine the industry standards for operational simplicity. The Sapphire Pro system offers reliability, functionality and connectivity.

Sapphire Pro offers an extensive range of tools to customize the system to meet the requirements of the user. Incorporated in the software are predefined operator types, time schedules and access groups that are suitable for use by the majority of system users. These features combined with bulk card loading and Auto Configuration ensure that the system is fully operational with a minimum of time and effort.

Sapphire Pro offers Database Partitioning and Multiple Server operation, with up to 32 fully functional workstations per server. Each server and workstation supports local report and event printing and may be used as an enrollment or assessment station for the integrated badging system.

Internet Browser Interface

Sapphire Pro utilizes the Microsoft Internet Explorer browser to offer a distinctive but familiar user interface. Ergonomically designed, the user interface is easy to use and offers a familiar Internet type of environment in which to enter database and configuration information.

Auto Config

This unique tool provides a means to get the system up and running in the shortest amount of time. Auto Configuration allows system programming and expansion by automatically detecting and configuring field hardware, readers, alarm points, modems and workstations. Once the field hardware has been detected, Sapphire Pro configures it automatically into the database for a fully functional access control system. Sapphire Pro also prompts you to batch add cards, activating them immediately. This provides a system that is ready to operate and allows you to customize later.

Badging

Create badges easily utilizing Sapphire Pro's integrated video badging and photo ID options found in the fully integrated badging system. The video badging and imaging features include a full badge design and drawing package with multi-layer design tools. The full editing package includes copy, paste, automatic centering and full drag and drop capabilities. The sophisticated photo capture tool provides vertical and horizontal photo centering controls, brightness, contrast, color, intensity and hue controls for the photo image. In addition, it features a multi-frame capture, which allows the subject to choose the best likeness from several photos. Camera settings can be stored for prevailing ambient light levels. Photos may be obtained remotely from video cameras and digital still cameras and imported from .jpg, .bmp, or .wmf file types.



Sapphire Pro

Sapphire Pro

Interactive Dynamic Color Graphics

Operators have full system control through the use of dynamic alarm, reader and relay icons displayed on graphic maps. The dynamic color graphics feature fully scalable alarm presentation with automatic zoom. Alarms can be acknowledged and cleared through the graphical maps together with full camera control, including pan-tilt-zoom. Maps have full drill-down capabilities to allow precise location of alarms to be determined.

Report Generation

Report generation could not be easier. Dozens of pre-configured reports are provided, arranged by cardholders, operators, individual device types (i.e. workstations, field panels, readers, alarms, relays) system events, alarm events, alarm history, and operator actions. In addition, the system is equipped with a point-and-click customizable Employee Report generator tool with multi-level filtering.

InVision

Sapphire Pro is compatible with the revolutionary InVision access control, CCTV switcher, digital video recorder (DVR) field mountable panel. InVision can simultaneously record and control up to eight fixed or PTZ cameras and control eight readers, biometric devices and/or keypads. Each Wavelet compressed event is simultaneously downloaded to the Sapphire Pro server, where it is synchronized with the alarm and event database for tagged video event recording and viewing.

Instant Access

Eliminate waiting for the download of database information to field panels with Sapphire Pro's Instant Access tool. Use this feature when it is necessary to download data to field panels over a dial-up modem, LAN or extended RS-485 communications link. The Instant Access feature ensures that the full functionality of the current database is available at any field panel location and provides for grants from the server.

Data Guard

This feature eliminates database corruption in field panels due to communication failures during downloads. In many cases a severed connection can leave a field panel unable to grant access or annunciate alarms. Data Guard retains the last complete panel database as a default until the update has been confirmed, ensuring the integrity of the database in the field panel.

Burglar Alarm Functionality

Sapphire Pro provides the resources for your total security system integration, including customizable LCD keypad displays for complete burglar alarm functionality. Area masking and reporting features include delayed ingress and egress arming, disarming and alarming, and central station reporting and integration.

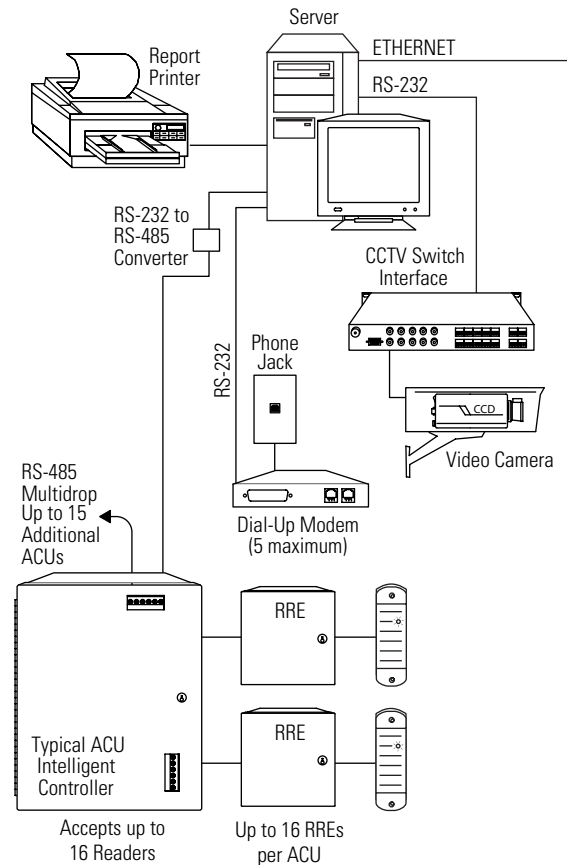

High-end access control for enterprise solutions

CCTV Camera and PTZ Control

Complete CCTV camera and PTZ control and display allows operators to view an entire area leaving nothing unseen. These features are available directly from the dynamic color graphics module.

Upgradeable/Backward Compatible

Sapphire Pro is upgradeable to much larger and more sophisticated functionality without the need to re-configure or re-enter any data into the system. Sapphire Pro systems come configured in modularly upgradable 16 to 512 reader packages. For further expansion to unlimited reader, alarm and relay capacity, it is simple to upgrade to any level of the powerful, field-proven Diamond II systems.

Tutorial

Sapphire Pro is designed with ease of use in mind by incorporating help text, manuals and flyover prompts.

Burglar Alarm Functionality

Sapphire Pro provides the resources for your total security system integration, including customizable LCD keypad displays for complete burglar alarm functionality. Area masking and reporting features include delayed ingress and egress arming, disarming and alarming, and central station reporting and integration.

Interactive Device Tree

Sapphire Pro provides a device tree for efficient updating and programming of any devices connected to the system. By selecting a device from the tree, the user can see the related information with a click of the mouse taking them immediately to the correct configuration screen.

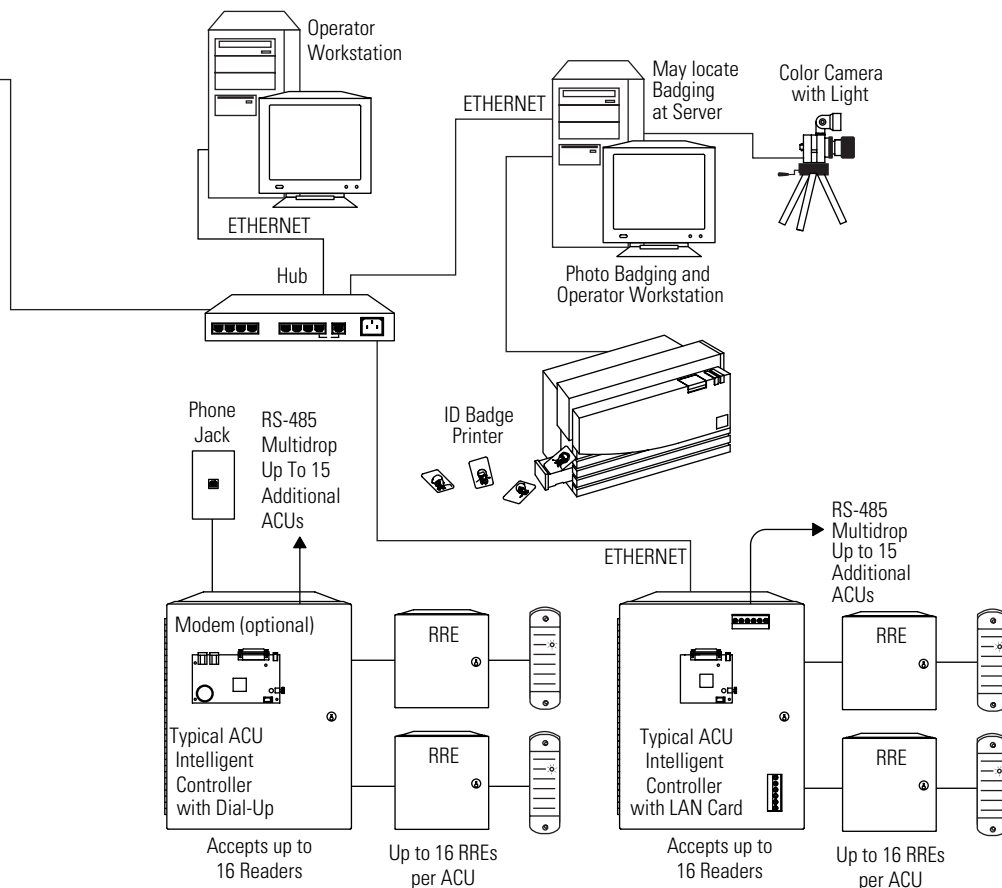

Sapphire Pro

High-end access control for enterprise solutions

Specifications

Maximum System Capacity

- Readers: 512
- Alarm Points: 10,000
- Security Areas: 2,000
- Serial Ports: 63
- Holidays: 32
- Log File Size: 400 MB
- Access Groups: 2,000
- Security Areas per Card: 128
- Color Graphics Maps: 1,000
- Access Groups per Card: 32
- Instruction Messages: 512
- Operator Groups (when using Partitioned Database Software): 254
- Cardholders: 20,000
- Remote Controls: 10,000
- Field Panels: 512
- Time Schedules: 255
- Operator Passwords: 512
- Workstations: 32
- Elevator Floors: 128

PC Requirements

- Pentium IV PC hardware
- Processor speed: 1 GHz minimum
- Windows 2000 Professional Operating System
- Monitor size: 15" minimum, 17" recommended
- Monitor resolution: 1024 x 768 pixels x 65,535 colors
- RAM: 512 MB minimum
- Video memory: 4 MB
- Hard disk space: 20 GB
- CD ROM drive: 20x
- Sound card and speakers: Yes
- Floppy disk: Required for workstation setup
- Video capture card: Optional
- External modem: Optional
- Serial RS-232 ports: 1 minimum
- Parallel ports: 1 minimum
- Ethernet card: TCP/IP required

Ordering Information

Part Number	Product Description
SAPPRO-16-SW	Supports: 16 readers, 4,096 alarm points and 4,000 cards
SAPPRO-32-SW	Supports: 32 readers, 4,096 alarm points and 4,000 cards
SAPPRO-64-SW	Supports: 64 readers, 4,096 alarm points and 10,000 cards
SAPPRO-128-SW	Supports: 128 readers, 10,000 alarm points and 10,000 cards
SAPPRO-250-SW	Supports: 250 readers, 10,000 alarm points and 20,000 cards
SAPPRO-500-SW	Supports: 500 readers, 10,000 alarm points and 20,000 cards
SAPPRO-WKSTN-SW	Workstation software
FAC-CONFIG	Factory loading and configuration of software on user-supplied computer
Configured Solutions - including PC and software	
SAPPRO-16-SVR	Configured server PC including SAPPRO-16-SW
SAPPRO-32-SVR	Configured server PC including SAPPRO-32-SW
SAPPRO-64-SVR	Configured server PC including SAPPRO-64-SW
SAPPRO-128-SVR	Configured server PC including SAPPRO-128-SW
SAPPRO-250-SVR	Configured server PC including SAPPRO-250-SW
SAPPRO-500-SVR	Configured server PC including SAPPRO-500-SW
SAPPRO-WKSTN	Configured workstation PC with SAPPRO-WKSTN-SW
Software and Hardware Upgrades	
SAP-UPTRAPRO-UPG	Sapphire Ultra to Sapphire Pro-16 software upgrade
SAPPRO-UPG	Sapphire Lite, 64 or 128 to equivalent Sapphire Pro software upgrade
DMDI-SAPPRO-UPG	Diamond to Sapphire Pro software upgrade
SAPPRO-32-SWUP	Sapphire Pro-16 to Sapphire Pro-32 software upgrade
SAPPRO-64-SWUP	Sapphire Pro-32 to Sapphire Pro-64 software upgrade
SAPPRO-128-SWUP	Sapphire Pro-64 to Sapphire Pro-128 software upgrade
SAPPRO-250-SWUP	Sapphire Pro-128 to Sapphire Pro-250 software upgrade
SAPPRO-500-SWUP	Sapphire Pro-250 to Sapphire Pro-500 software upgrade

Additional Sapphire Pro parts can be found in the price guide.



www.infographicsystems.com
www.GE-Interlogix.com

7373 Lincoln Way
Garden Grove, CA 92841
Phone: 714-890-0083
Fax: 714-890-0093

GE Interlogix
InfoGraphics