

# LATCH / BOLT MONITOR

*Monitor Actual Latch Or Bolt Status, Not Just A Closed Door!*

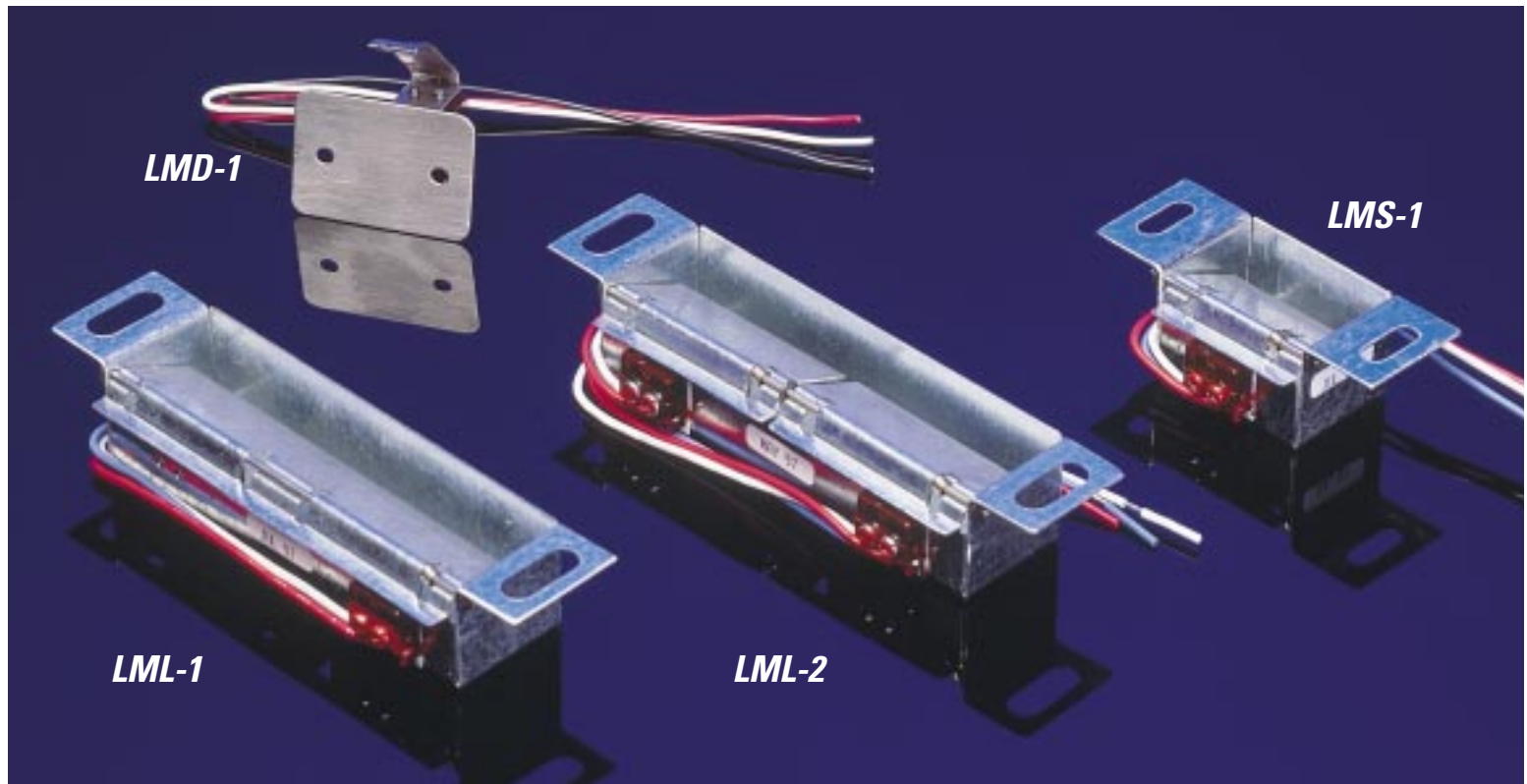

## OVERVIEW

By **electronically verifying** mechanical latch and bolt positions, Securitron LM Series latch monitors detect and report to the building alarm or access control system that a door is actually latched or bolted, not just closed. They install easily, are concealed behind existing hardware, and **require no jamb or strikeplate modification**.

**Three models in two sizes accept all North American latches or bolts.** The innovative patented design automatically copes with variations between different brands of latching hardware without requiring installer adjustments. The **LMS-1** includes a single SPDT switch and fits any standard 2 3/4" ANSI cut-out. The **LML-1** also has a single SPDT switch and fits any standard 4 7/8" ANSI cut-out. The **LML-2** monitors a mortise latch and deadbolt separately, features two separate SPDT switches, and fits any standard 4 7/8" ANSI cut-out.

When monitoring hook or swing bolts, **conventional magnetic contacts report a door as simply closed**, without confirmation that it's secure. The deadlock monitor model **LMD-1** can be used with an Adams Rite MS type deadlock or similar brand to report the locked or unlocked status of **narrow stile aluminum frame doors**, including sliding glass doors. And the LMD-1 installs quickly in door frame stiles without routing—just three holes to drill!

## COMMON APPLICATIONS

The primary value of the Latch Monitor family is to deliver **higher security** through reporting the **latched or bolted status** of doors with a building, rather than merely reporting that they are closed—or nearly closed. The operating gaps associated with magnetic contacts make

them report secure even when a door is not latched, so long as it is almost closed. Securitron's Latch Monitor series eliminates this weakness with a simple, reliable and universal design.

**Retail stores** provide a particularly pertinent example of the latch monitor's value. Larger shops will have numerous aluminum frame glass (storefront) doors leading outside. At closing time it's all too easy for a clerk to forget to lock down one of these doors prior to arming the alarm system and leaving. This condition invites quick entry and theft, or a false alarm event when wind pushes the door partially open. **Use of the LMD-1 insures that all doors are locked**, or the system will not arm.

A secondary use of the latch monitor is to **initiate delayed exit** when an interior latch is withdrawn on a door equipped with a Magnalock and Securitron's model XDT logic timer.

## FIGHT FALSE ALARMS!

False alarms are not only embarrassing to a system owner, but are also costly when **police departments levy false alarm fines** aimed at reducing the waste of law enforcement resources. An important cause of false alarm occurs when an armed system reports a nearly closed but unlatched or unbolted door as secure. The door subsequently swings open from the wind or is moved by an individual without criminal intent, and police are erroneously dispatched.

Using a Latch Monitor completely eliminates this kind of problem. And for many installations, Latch Monitors are inexpensive enough to be employed in all the doors—or alternately—they can be selected for those critical openings most subject to this type of false alarm event.



LMD-1

The LMD-1 employs a spring steel arm which deflects as a deadlock slides into locked position. The relatively long arm provides ample margin for error in mounting position.

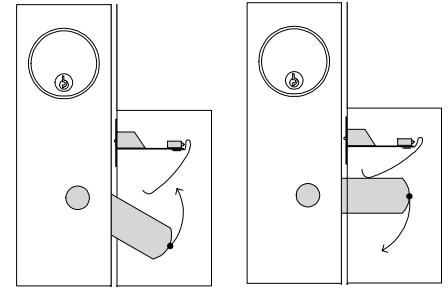

**EASY INSTALLATION**

**For Wooden Door Frames:** Simply remove the strikeplate—chisel for increased depth if necessary—make electrical connections, insert unit and replace the strikeplate.

**For Metal Door Frames:** Metal frames may require minimal filing or tab removal in some cases.

**LMD-1 Installation in Aluminum Frames:** Drill one, central 9/16" (15MM) hole, and two 1/8" (3mm) holes. Drive rivets are supplied which seat the unit flush to the frame with only a hammer tap.

Note that each unit is furnished with a 6' (2m) jacketed cable so that splicing need never be done within the door frame.

**AS PART OF EXIT DELAY**

Latch Monitors are an integral part of any complete Magalock Exit Delay system.



Securitron's Family of Exit Delay Components

PUSH UNTIL ALARM SOUNDS  
DOOR CAN BE OPENED IN 15 SECONDS

Where mortise hardware is present, wiring to the strike is accessible and tampering is a minor concern, an LM series latch monitor is ideal for delay initiation. Mounted right behind the strike, it operates by detecting latch withdrawal during an exit attempt.

**TECHNICAL DATA**

**Contact Rating:**

SPDT, 2 Amps @ 24 Volts

**Operating Temperatures:**

-40°F to 160°F (-40°C to 71°C)

**Dimensions:**

- LMS-1 Single for ANSI 2-3/4" strike: 2-5/8" x 1-3/16" x 7/8"
- LML-1 Single for ANSI 4-7/8" strike: 4-5/8" x 1-3/16" x 7/8"
- LML-2 Double for ANSI 4-7/8" strike with dead bolt: 4-5/8" x 1-3/16" x 7/8"
- LMD-1 Single for use with aluminum frame deadlocks.

U.S. Patent #5,757,269 and #5,825,288

**ORDERING INFORMATION**

LMS-1 for any latch or bolt seated in an ANSI 2 3/4" strike.

LML-1 for any latch or bolt seated in an ANSI 4 7/8" strike. (In the case of a mortise lock with combined latch and bolt in a 4 7/8" strike, the LML-1 will report secure when either the latch or bolt is engaged.)

LML-2 for a mortise lock with combined latch and bolt in an ANSI 4 7/8" strike when you wish to separately monitor the latch and/or bolt.

LMD-1 for narrow stile deadlock or hookbolts used in storefront or sliding doors such as Adams Rite MS series.

Part Number	Description	Price
LMD-1	Latch Monitor For Aluminum Door Deadlock SPDT 3 Amp	\$30.00
LML-1	Latch Monitor ANSI 4 7/8" SPDT 3 Amp	\$30.00
LML-2	Latch Monitor ANSI 4 7/8" w/ Deadbolt SPDT 3 Amp	\$50.00
LMS-1	Latch Monitor ANSI 2 3/4" SPDT 3 Amp	\$25.00

**REVOLUTIONARY**  
 rev•o•lution•ary (rēv'•e•lōō•shē•nērē) adj. 1. Marked by or resulting in extreme change <a revolutionary invention>

**UNLATCH™**

Not Merely A New and Better Electric Strike... But A Genuine Revolutionary Advancement!

The Architect... Can design the cosmetically seamless Unlatch into new construction or retro-fit confident that the installation will function flawlessly and security will never be compromised.

The Installer... Doesn't need locksmithing skills because no door frame modifications are required. The Unlatch works with any cylindrical lock on all door types. Mechanical installation takes only seconds and results in perfect finished appearance every time.

Access Control Professionals... Get undetectable installations that release under pre-load pressure while maintaining full deadlatch function. The Unlatch also provides latch status monitoring to the alarm system and unmatched resistance to vandalism and abuse.

- Quick & Easy to Install
- No Locking Required. Fits Any Standard ANSI 6 7/8" Cutout
- Home "C" Latch Status Monitor
- Operates From Inset Or in Pre-Installed
- More Secure Than A Traditional Over's Set
- Maintains Full Deadlatch Function
- Two Year Warranty
- Made in USA

**MOTORIZED ELECTRONIC STRIKE**

**SECURITRON**

**STATE OF THE ART SMART!™**